

Bruken Digital Lock Install Instructions

Experience a safer
and more open world

Changing Handing

- 1 Remove thumbturn faceplate by removing the 4 screws on the side of the lock.
- 2 Disconnect the power supply from the thumbturn side.
- 3 Remove the four screws from the keypad to remove from mounting bracket. Rotate the keypad 180° to change handing, then reinstall to mounting bracket with 4 screws that were removed.
- 4 Reconnect the power supply before connecting the thumbturn side back on to the mounting bracket.

Installing Lock on Glass Door

- 1 Clean glass prior to installation. Remove film from the adhesive of the lock body mounting plate. Use the mounting tabs to position the mounting plate to the edge of the door. Apply pressure until mounting is securely adhered to the door.
- 2 Remove 4 screws from the thumbturn side and unplug power supply.
- 3 Slide keypad and mounting bracket over the mounting plate adhered to the door.

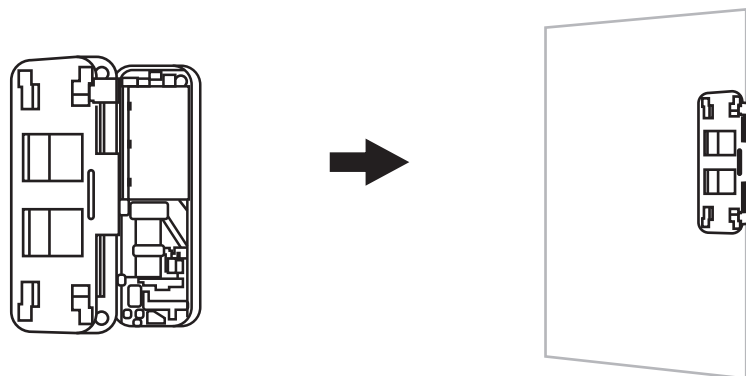

- 4 Position the 5 screw holes on the mounting bracket with the mounting plate and install screws provided in the box.
**Recommend not using a drill and hand tightening with screw driver. Screws do not need to be fully seated, tighten down till snug.*

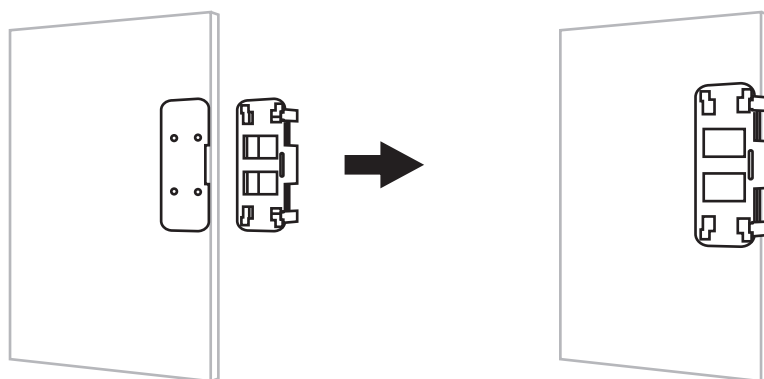

- 5 Reconnect power supply and install thumbturn side on bracket with the 4 screws removed previously.

Installing Keeper on Glass Door

- 1 Clean glass prior to installation. Remove film from the adhesive of the keeper body mounting plate. Use the mounting tabs to position the mounting plate to the edge of the door. Apply pressure until mounting is securely adhered to the door. Make sure the lock body and keeper body are at the same height.
- 2 Remove 4 screws from the side of the keeper.
- 3 Slide keeper and mounting bracket over the mounting plate adhered to the door.

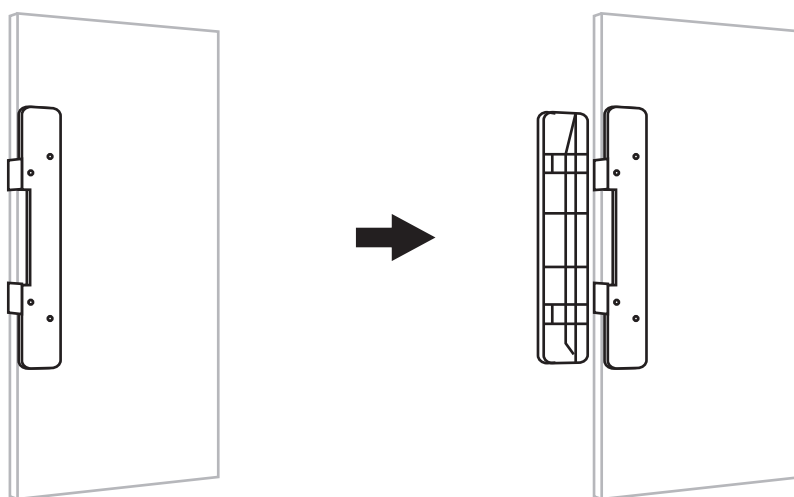

- 4 Position the 5 screw holes on the mounting bracket with the mounting plate and install screws provided in the box.
**Recommend not using a drill and hand tightening with screw driver. Screws do not need to be fully seated, tighten down till snug.*
- 5 Reinstall the keeper faceplate with the 4 screws previously removed.

